



UDUIT has a range of design solutions to help you add functionality to your kitchen while maximising the use of your cupboard space. These solutions include **Base corner Pullout** cabinets, **On Bench Pantry** cabinets, as well as other affordable cabinets that will allow for easy access. UDUIT also has a series of Oven towers for most oven configurations from a single oven to a double oven.

Along with our flexible width option, it is possible to amend the Heights and Depths of our cabinets. This depends on the cabinet type and the size limitations.

The designer cabinet range and upgrades are available on **request only**. Because of the technical requirements of these cabinets we add these cabinets to your quote for you. Simply generate an online quote of the other items in your design. Then email us the details of the cabinet you require and we will add this to your quote for you.

NOTE: changes to size, colour and construction may differ from that shown. Please confirm with UDUIT as to your needs.

Height and Depth changes to cabinets. Depending on the cabinet type it is possible to amend sizes within limits. Please email once you have done an online quote.

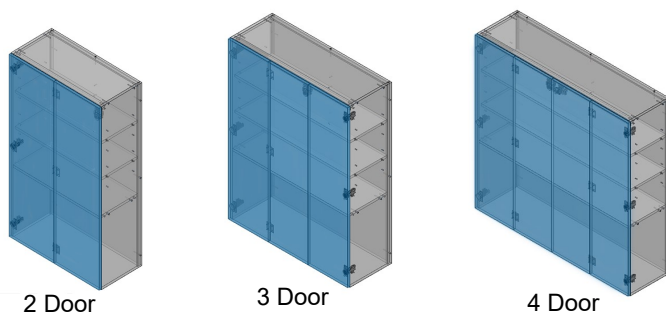

2 Door

3 Door

4 Door

OnBench Pantry Cabinet

Cabinet Size

Height from 900mm to 1500mm

Width from 600mm to 1000mm

Depth from 250mm to 560mm

Sizes will determine door configuration.

- 2 door, 3 door, and 4 door bifold options, dependant on size

Can be ordered in variable heights, width and depths to suit bench height.

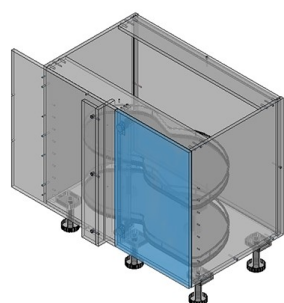

Cabinet Size

H = 870mm

W = 900mm

D = 628mm

Comes with Lemans pullout shelving system

Important info

Cabinet requires 1080mm space



Base Blind cabinet with Lemans Pullout

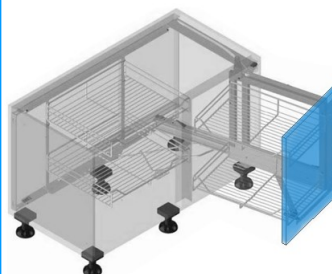

Cabinet Size

H = 870mm

W = 900mm

D = 628mm

Comes with Magic corner pullout shelving system

Important info

Cabinet requires 1080mm space



Base Blind cabinet with Magic corner pullout

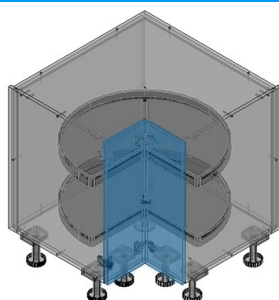

Cabinet Size

H = 870mm

W = 900mm

W = 900mm

D = 580mm

Comes with Lazy susan shelving system



Base corner Cabinet 900 x 900 with Lazy Susan



Cabinet Size

H = 870mm

W = 900mm

W = 900mm

D = 580mm

Unit is supplied preassembled

Doors will need to be fitted

Doors fold into unit

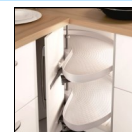

Mondo Base corner cabinet 900 x 900

Drawer Pantry cabinets

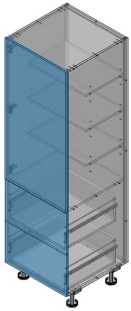

Cabinet Size
H = 1500 to 2250 ex 150mm toespace
W = 300 to 600
D = 540 to 700mm

1 Door 2 Drawer Pantry Cabinets

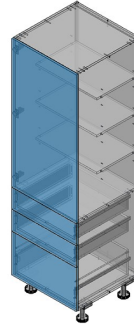

Cabinet Size
H = 1500 to 2250 ex 150mm toespace
W = 300 to 600
D = 540 to 700mm

1 Door 3 Drawer Pantry Cabinets

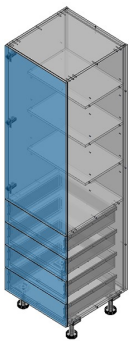

Cabinet Size
H = 1500 to 2250 ex 150mm toespace
W = 300 to 600
D = 540 to 700mm

1 Door 4 Drawer Pantry Cabinets

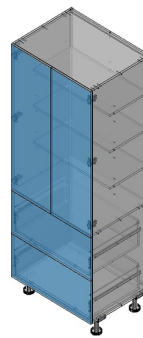

Cabinet Size
H = 1500 to 2250 ex 150mm toespace
W = 600 to 1000mm
D = 540 to 700mm

2 Door 2 Drawer Pantry Cabinets

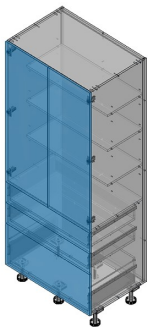

Cabinet Size
H = 1500 to 2250 ex 150mm toespace
W = 600 to 1000mm
D = 540 to 700mm

2 Door 3 Drawer Pantry Cabinets

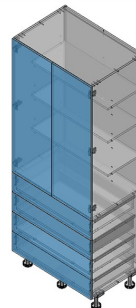

Cabinet Size
H = 1500 to 2250 ex 150mm toespace
W = 600 to 1000mm
D = 540 to 700mm

2 Door 4 Drawer Pantry Cabinets

Pullout Pantry cabinets

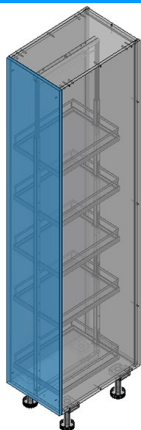

Cabinet Size
H = 2086mm incl 150mm toespace
W = 300mm or 400mm
D = 609mm overall depth

Comes predrilled for
pullout shelving system
Includes Chrome pullout
with 5 chrome wire baskets

Pullout Pantry - Chrome basket

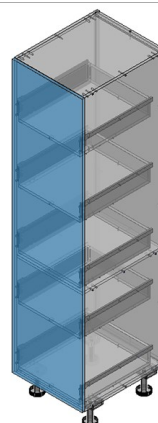

Cabinet Size
H = 2086mm incl 150mm toespace
W = 300mm to 600mm
D = 609mm overall depth

5 Drawers attached to 1
front

Pullout Pantry - Drawer system

Oven cabinets

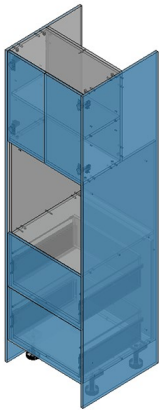

Cabinet Size
H = 2086 to 2400mm
W = 634
D = 560 to 700mm

For single built in ovens

Appliance size will determine suitability of oven tower. Check with UDUIT, email the Make and model.

Bench Height single Oven Tower

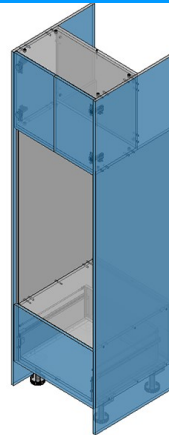

Cabinet Size
H = 2086 to 2400mm
W = 634
D = 560 to 700mm

For Double ovens 850 to 1250mm high

Appliance sizes will determine suitability of oven tower. Check with UDUIT, email the Make and model.

Double Oven Tower 2 doors & 1 Drawer

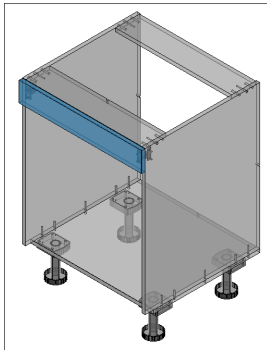

Cabinet Size
H = 720 + 150mm toespace
W = 600 to 900
D = 560 to 700mm

For Induction hobs above an oven.

Appliance size will determine suitability of oven tower. Check with UDUIT, email the Make and model.

Base Oven for Induction Hob

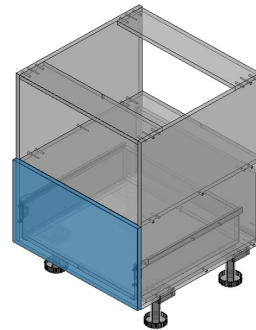

Cabinet Size
H = 720 + 150mm toespace
W = 600 to 900
D = 560 to 700mm

For oven heights between 400mm high and 500mm high

Appliance size will determine suitability of oven tower. Check with UDUIT, email the Make and model.

Base Oven 1 drawer for 3 Quarter Oven

Pantry Corner Cabinet

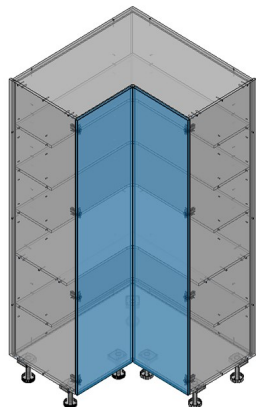

Cabinet Size
H = 1500 to 2250 ex 150mm toespace
WL = 900 to 1050
WR = 900 to 1050
DL = 490 to 700mm
DR = 490 to 700mm

Pantry L Shaped 2 door Cabinet

Oven cabinets

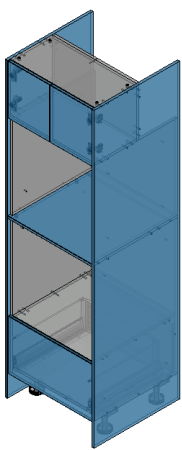

2 Single Ovens

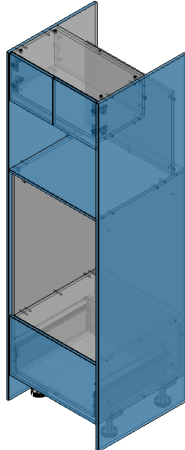

1&1/2 Ovens & Microwave

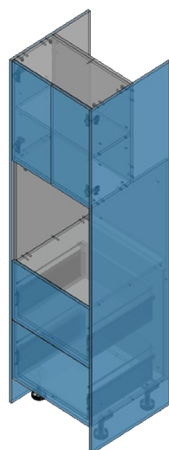

Bench Height Single Oven

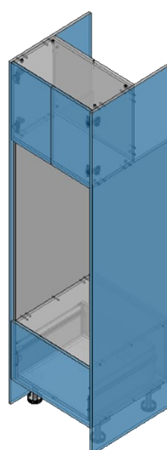

Double Oven

Cabinet Size

H = 2086 to 2400mm

W = 634

D = 560 to 700mm

Appliance size will determine suitability of oven tower.

Check with UDUIT, email us the Make and model.

Cabinet Size

H = 720

W = 600 to 900mm

D = 560 to 700mm

Check with UDUIT, email us the Make and model.

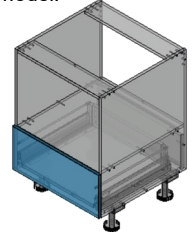

1 Drawer for 3 Quarter Oven
600 to 900 wide

Oven Towers

The oven tower will need to be added to a quote you have generated online. Once you have done this email us the make and model of the appliance as well as the preferred tower type. NOTE some towers have size limitations.

Décor Scullery coloured Cabinet range



The décor cabinet range is a coloured cabinet that has no fronts. It is limited to the cabinets shown. They are flexible in height width and depth within set limits. Suitable for anywhere you want an open shelf cabinet. Some end panels and kick boards may be required to complete the look.

Concealed Drawer Pantry cabinet

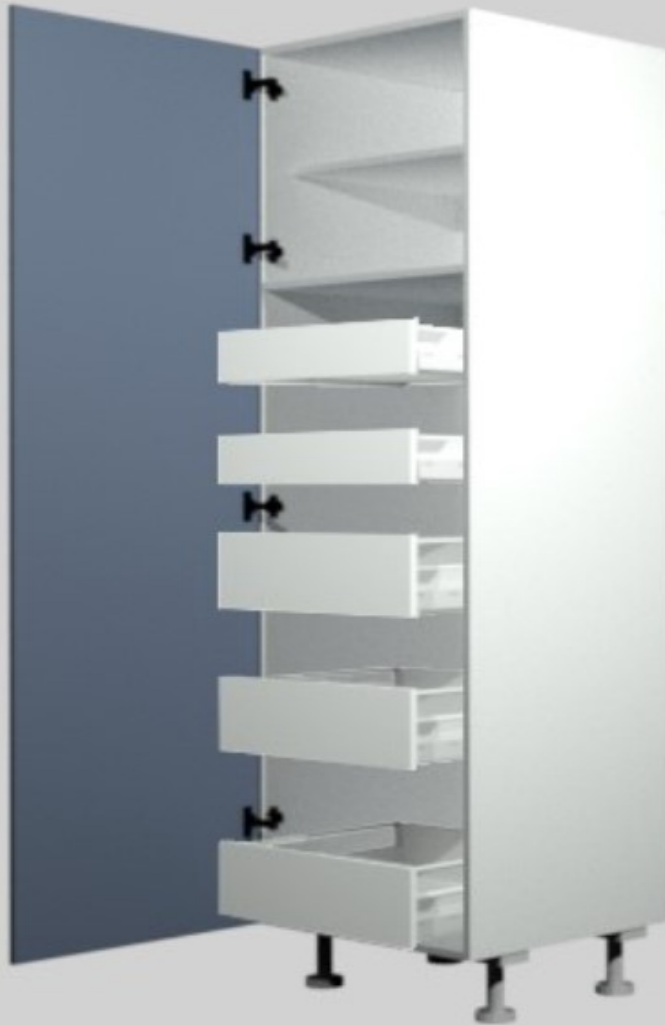

- Simple and accessible storage.
- Upgraded drawer system.
- 3 large and 2 small drawers to allow easy access and better storage.
- Full height pantry door allows for a cleaner look with less visible lines.
- Available in 1 and 2 door cabinets.

Cabinet size range

Cabinet 1 door LH & RH

Height 1936mm (2086mm) to 2250 (2400mm)

Width 300mm to 600mm

Depth 560mm to 700mm excluding front thickness

Cabinet 2 door

Height 1936mm (2086mm) to 2250 (2400mm)

Width 600mm to 1000mm

Depth 560mm to 700mm excluding front thickness

Base pullout cabinets with Chrome Baskets

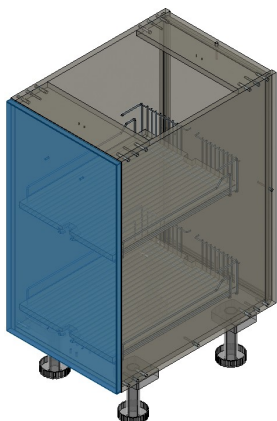

Cabinet Size

H = 720 + 150mm toespace

W = 300 or 400

D = 560 mm

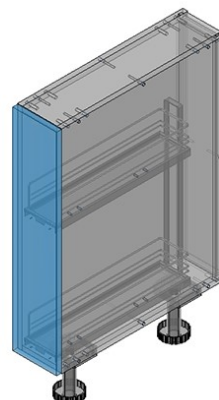

Cabinet Size

H = 870mm

W = 150mm

D = 580mm



Comes with Base pullout shelving system in chrome

Base Pull Out 1 Door (2 Baskets) Chrome

Base 1 door 150mm wide chrome pullout

Upgrade your drawer hardware

The upgraded drawer system offers an affordable stylish solution with integrated softcloser. The full extension drawer system has been tested to archive a full 35kg weight capacity, making it durable and reliable.

The drawer system is available in all UDUIT drawer configurations.

Ask for a quote and see how affordable this system is. Simply complete an online quote using the standard drawer range. Make sure you generate a quote first. Then email us to swap the drawers for the Alto range of drawers and we will do this for you.



[How do you add cabinets from the Designer range to your quote.](#)

Firstly complete a free online quote. Add in the other cabinets and panels you require into the basket and then generate a quote and complete the process. This will automatically generate a login where the quote will be saved.

Once you have done your initial quote email us the details of the cabinet or cabinets you require. Overall dimensions. Height x width x depth.

Because of some of the technical aspects of these cabinets we may ask you a few questions as well as verify size requirements of some of the cabinets.

We will then add the cabinet to your quote for you.

[Designer range - things you should know.](#)

Non-standard cabinets are supplied in a bulk format. This means the cabinets are still packed by cabinet but the hardware will be supplied in bulk.

Instructions for specific hardware items may be included separately with the hardware item as supplied by the hardware supplier.

The assembly instructions supplied may need to be used in conjunction with hardware installation instructions.

Designer range cabinets will also extend the lead time by 1 or 2 working days. You will be advised at the time of ordering via the system. Please check the dispatch date on the order.